



MY CO-OP



48th Annual

PARADE OF HOMES

**JUNE
11-18**

TOUR THE MOST BEAUTIFUL HOMES

in the Chippewa Valley

8 New Homes • 2 Remodeled Homes • 4 Virtual Homes

(2 Remodels & 2 New Homes) can be viewed virtually

Parade Home Hours

June 11 & 12* 10:00 A.M. - 5:00 P.M.

June 13 - 17 5:00 P.M. - 9:00 P.M.

June 18 10:00 A.M. - 5:00 P.M.

**Remodeled Homes are open June 11 & 12*

Tickets

\$8 through June 10

\$10 after June 10



**Eau Claire Energy
Cooperative**

Your Touchstone Energy® Partner

Tickets are available at

1st Parade Home You Visit • www.ParadeOfHomesCV.com

Royal Credit Union Branches in Eau Claire, Chippewa Falls & Menomonie **through June 10**



All Title Services Inc • Citizens State Bank - Cadott, Chippewa Falls, Cornell

Everyday Surveying & Engineering, LLC • Gerhard's Kitchen & Bath Store

JM Builders LLC • Kristy Thiess, Your Real Estate Guide • Legends Title Services, LLC

JASK Visual • iHeart Media • WEAU 13 News

www.ParadeOfHomesCV.com

YOUTH AMBASSADORS VISIT EAU CLAIRE HUMANE ASSOCIATION

By Adam Westaby

Eau Claire Energy Cooperative's Youth Ambassadors spent the month of April collecting donations for their Pet Supply Drive to support the Eau Claire County Humane Association. The students delivered the donations to the shelter, and received a tour from Executive Director Shelley Janke and Marketing & Development Director Addie Erdmann. The students were given a behind-the-scenes look throughout the shelter and gained a much better understanding of what it takes to care for so many animals. Our Youth Ambassadors also made a passionate plea for ECEC to have a "Youth Ambassador cat" added to the office—unfortunately, their petition was unsuccessful.





JUNE IS DAIRY MONTH!



Eau Claire Energy Cooperative employees visited Feed My People Food Bank this month. Taylor Skibba and Jeni Thorpe dropped by and made a donation on behalf of ECEC. The cooperative donated six gallons of milk, six pounds of butter, and various cheeses to help those in our community. In honor of June Dairy Month, many families in our area will have fresh dairy products added to their refrigerator. It is important to the cooperative to support those in our community and support our local farmers! As part of Cooperative Principle #7, concern for community, we take pride in supporting our community in any way we can. Thank you to all of our dairy farm members for working so hard to provide our communities with the best quality products around!



Delicious Dairy Facts About Milk



Got milk? Milk is the only food that you can survive on alone. It has every nutrient you need.



The world loves milk. The world's population consumes over 2.1 billion liters every day. That's enough to fill up 813 Olympic-size pools.



Cows have friends. Dairy cows are social animals. Like people, they will make friends and bond with some, while avoiding others.



Cows can produce a ton of milk. A cow turns grass into milk within two to three days. Depending on the breed, a cow can make between 25 and 40 liters of milk per day.



MAJOR CONSTRUCTION AT ECEC HEADQUARTERS

Anyone who has visited ECEC headquarters recently will have noticed the major renovations going on out back. Eau Claire Energy Cooperative is currently in the process of renovating our garage and warehouse spaces. As you can imagine, this is a large undertaking that is affecting our parking at the office, the storage of our equipment, and our daily operations. We ask that in this process, our members remain safe when visiting our office by not entering the construction area behind the building. Our lobby remains open and ready to serve you. Please don't hesitate to stop! We are available to answer any questions and give assistance to our members. We also ask that our members

be patient with noise or other construction-related delays when in our office. Your cooperative remains dedicated to providing you with safe and reliable power and we are continuing to make that a priority in the future.

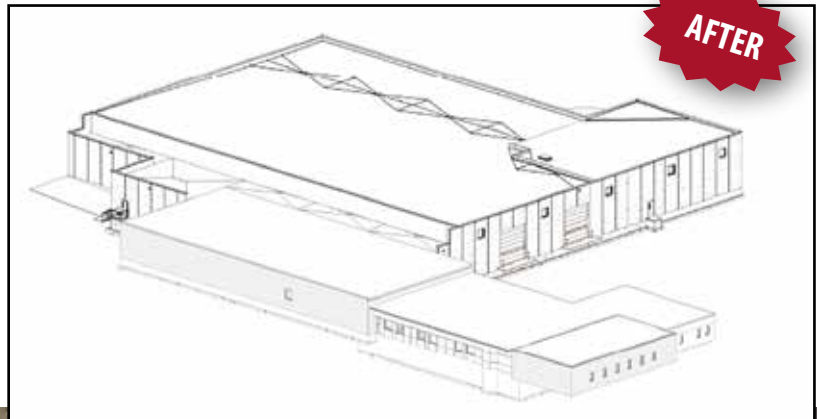

Eau Claire Energy Cooperative

Your Touchstone Energy® Partner



Monica Obrycki, President and CEO

**Taylor Skibba, Marketing and
Communications Coordinator**

8214 Hwy 12, P.O. Box 368, Fall Creek, WI 54742-0368
www.ecec.com 

Office Hours: 7:30 a.m.–4 p.m. Mon–Fri

Non-emergencies: 715-832-1603

Emergencies & outages: Toll FREE 800-927-5090
24 hours a day, 7 days a week

Diggers Hotline: 811 or 1-800-242-8511
Call 3 working days before you dig.

Eau Claire Energy Cooperative's office will be closed Monday, July 4, for Independence Day